

Tiger Pro 72HC

540-560 Watt

MONO-FACIAL MODULE

P-Type

Positive power tolerance of 0~+3%

IEC61215(2016), IEC61730(2016)

ISO9001:2015: Quality Management System

ISO14001:2015: Environment Management System

ISO45001:2018

Occupational health and safety management systems



MBB HC Technology

Key Features



Multi Busbar Technology

Better light trapping and current collection to improve module power output and reliability.



Durability Against Extreme Environmental Conditions

High salt mist and ammonia resistance.



Reduced Hot Spot Loss

Optimized electrical design and lower operating current for reduced hot spot loss and better temperature coefficient.



Enhanced Mechanical Load

Certified to withstand: wind load (2400 Pascal) and snow load (5400 Pascal).



Longer Life-time Power Yield

0.55% annual power degradation and 25 year linear power warranty.



POSITIVE QUALITY™
Continuous Quality Assurance

LINEAR PERFORMANCE WARRANTY

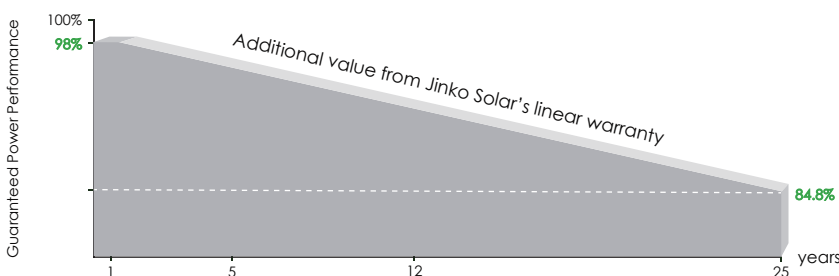

12 Year Product Warranty

25 Year Linear Power Warranty

0.55% Annual Degradation Over 25 years

Engineering Drawings

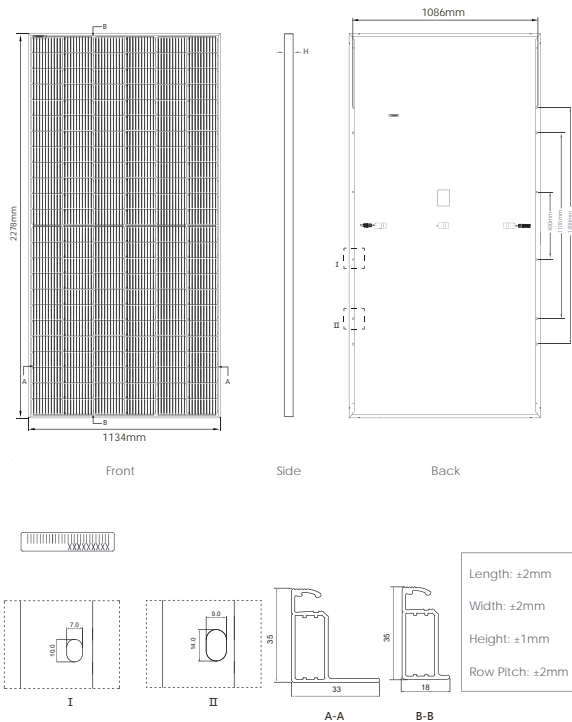

Packaging Configuration

(Two pallets = One stack)

31pcs/pallets, 62pcs/stack, 620pcs/ 40'HQ Container

Electrical Performance & Temperature Dependence

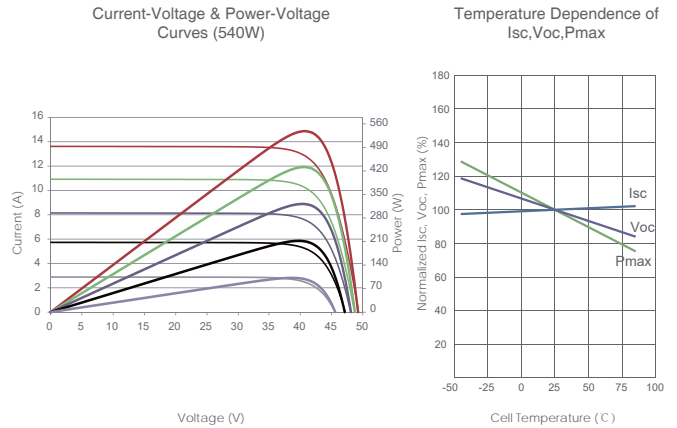

Mechanical Characteristics

Cell Type	P type Mono-crystalline
No. of cells	144 (6×24)
Dimensions	2278×1134×35mm (89.53×44.65×1.38 inch)
Weight	28 kg (61.73 lbs)
Front Glass	3.2mm, Anti-Reflection Coating, High Transmission, Low Iron, Tempered Glass
Frame	Anodized Aluminium Alloy
Junction Box	IP68 Rated
Output Cables	TUV 1×4.0mm ² (+): 400mm, (-): 200mm or Customized Length

SPECIFICATIONS

Module Type	JKM540M-72HL4		JKM545M-72HL4		JKM550M-72HL4		JKM555M-72HL4		JKM560M-72HL4	
	STC	NOCT	STC	NOCT	STC	NOCT	STC	NOCT	STC	NOCT
Maximum Power (Pmax)	540Wp	402Wp	545Wp	405Wp	550Wp	409Wp	555Wp	413Wp	560Wp	417Wp
Maximum Power Voltage (Vmp)	40.70V	38.08V	40.80V	38.25V	40.90V	38.42V	40.99V	38.59V	41.09V	38.69V
Maximum Power Current (Imp)	13.27A	10.55A	13.36A	10.60A	13.45A	10.65A	13.54A	10.70A	13.63A	10.77A
Open-circuit Voltage (Voc)	49.42V	46.65V	49.52V	46.74V	49.62V	46.84V	49.72V	46.93V	49.82V	47.02V
Short-circuit Current (Isc)	13.85A	11.19A	13.94A	11.26A	14.03A	11.33A	14.12A	11.40A	14.21A	11.48A
Module Efficiency STC (%)	20.90%		21.10%		21.29%		21.48%		21.68%	
Operating Temperature(°C)	-40°C~+85°C									
Maximum system voltage	1000/1500VDC (IEC)									
Maximum series fuse rating	25A									
Power tolerance	0~+3%									
Temperature coefficients of Pmax	-0.35%/°C									
Temperature coefficients of Voc	-0.28%/°C									
Temperature coefficients of Isc	0.048%/°C									
Nominal operating cell temperature (NOCT)	45±2°C									

*STC: Irradiance 1000W/m²

Cell Temperature 25°C

AM=1.5

NOCT: Irradiance 800W/m²

Ambient Temperature 20°C

AM=1.5

Wind Speed 1m/s